

**AGENDA**  
**REGULAR DRAINAGE MEETING**  
**Wednesday, April 1, 2020 9:30 AM**  
**Large Conference Room**

**County Buildings are closed to the public due to Covid-19 concerns, this meeting will be open to the public via conference call only. The meeting date and time will remain the same. You may call at that time to access the hearing by following the instructions below:**

**To access the meeting call: 1-(312)-626-6799, when prompted enter meeting  
ID code: 662 016 552**

**You can also access the meeting online at:  
<https://zoom.us/j/662016552>**

1. Open Meeting
2. Approve Agenda
3. DD 9 - Consider Bids With Possible Action On Bids

Documents:

[DD 9 BID TAB.PDF](#)  
[DD 9 CONTRACTOR QUALIFICATION STATEMENT FARM TILE PRO.PDF](#)

4. DD 25 - WO 01- Discuss W Possible Action - Contractor Update

Documents:

[DD 25 - 6501 INVESTIGATION MAP 03\\_35\\_20.PDF](#)

5. DD 14 WO 290 - Discuss W Possible Action  
DD 14 - WO 290 - David Sweeney reports 2 tile blowouts in waterway.

Documents:

[DD 14 WO 290.PDF](#)  
[DD 14 WO 290 REPAIR REQUEST 03\\_31\\_20.PDF](#)

6. DD 34 - WO 289 Discuss W Possible Action  
DD 34 - Korey Hake reports plugged tile/intake in ditch, ditch is full of water on both sides, roadbed is saturated w hole in side of road. Ponding in field on N side of rd, and water moving across Hake's field on the S side of rd. Located on 300th St, about 1/2 mile E of Zublin Ave.

Documents:

[DD 34 WO 289.PDF](#)  
[DD 34 WO 289 MAP.PDF](#)

7. DD Big 4 - WO 2020-5 - Discuss W Possible Action - Midland Power Drainage Utility Permit Application

DD Big 4 - WO 2020-5 - Midland Power requests Drainage Utility Permit for overhead line rebuild, 4 miles, Alden Twp, Sections 04, 05, 06, 08.

Documents:

[WO 2020-5 MIDLAND DRAINAGE UTILITY PERMIT.PDF](#)

[WO 2020-5 MIDLAND DRAINAGE UTILITY PERMIT APPLICATION.PDF](#)

8. Other Business
9. Adjourn Meeting



**PROJECT:** UPPER MAIN TILE DIVERSION  
DD 9, HARDIN COUNTY, IA  
**DATE:** MARCH 25, 2020  
**ENGINEER:** CLAPSADDLE-GARBER ASSOCIATES

**Mort's Water Company**  
1410 Gull Ave.  
PO Box 579  
Latimer, IA 50452

**Nettleton Excavating, Inc**  
269 370th Street  
Joice, IA 50446

**Hall Backhoe & Tiling**  
110 Progressive Ave.  
PO Box 1  
Roland, IA 50236

**Gehrke Inc.**  
1405 21st Ave.  
Eldora, IA 50627

**Farm Tile Pro**  
4121 Hwy 218  
Osage, IA 50461

**ENGINEER'S ESTIMATE \$140,000**

Item No.	Description	Estimated Quantity	Unit	Unit Price	Bid Price	Unit Price	Bid Price	Unit Price	Bid Price	Unit Price	Bid Price	Unit Price	Bid Price
<b>DD 9 BASE BID</b>													
1	15" Ø Polypropylene Tile	2530	LF	\$ 51.16	\$ 129,434.80	\$ 38.00	\$ 96,140.00	\$ 52.00	\$ 131,560.00	\$ 35.00	\$ 88,550.00	\$ 37.00	\$ 93,610.00
2	18" Ø CMP Tile Outlet	40	LF	\$ 113.75	\$ 4,550.00	\$ 48.00	\$ 1,920.00	\$ 52.50	\$ 2,100.00	\$ 129.00	\$ 5,160.00	\$ 50.00	\$ 2,000.00
3	Junction Structure	1	EA	\$ 5,000.00	\$ 5,000.00	\$ 4,000.00	\$ 4,000.00	\$ 1,483.00	\$ 1,483.00	\$ 6,380.00	\$ 6,380.00	\$ 6,000.00	\$ 6,000.00
4	Concrete Collar	4	EA	\$ 1,975.00	\$ 7,900.00	\$ 250.00	\$ 1,000.00	\$ 350.00	\$ 1,400.00	\$ 250.00	\$ 1,000.00	\$ 500.00	\$ 2,000.00
5	Private Tile Connection	4	EA	\$ 625.00	\$ 2,500.00	\$ 450.00	\$ 1,800.00	\$ 450.00	\$ 1,800.00	\$ 606.00	\$ 2,424.00	\$ 400.00	\$ 1,600.00
6	12" Ø Hickenbottom Intake	2	EA	\$ 1,975.00	\$ 3,950.00	\$ 1,500.00	\$ 3,000.00	\$ 1,252.00	\$ 2,504.00	\$ 775.00	\$ 1,550.00	\$ 1,300.00	\$ 2,600.00
7	Rip-Rap	40	TN	\$ 85.00	\$ 3,400.00	\$ 56.00	\$ 2,240.00	\$ 50.00	\$ 2,000.00	\$ 50.00	\$ 2,000.00	\$ 45.00	\$ 1,800.00
8	Tile Removal	10	LF	\$ 400.00	\$ 4,000.00	\$ 20.00	\$ 200.00	\$ 4.00	\$ 40.00	\$ 24.00	\$ 240.00	\$ 10.00	\$ 100.00
9	Fences	1	LS	\$ 1,500.00	\$ 1,500.00	\$ 1,500.00	\$ 1,500.00	\$ 200.00	\$ 200.00	\$ 1,500.00	\$ 1,500.00	\$ 100.00	\$ 100.00
10	Rebuild Terrace	2	LS	\$ 1,980.00	\$ 3,960.00	\$ 1,500.00	\$ 3,000.00	\$ 420.00	\$ 840.00	\$ 1,500.00	\$ 3,000.00	\$ 250.00	\$ 500.00
11	Outlet Shaping	1	LS	\$ 2,500.00	\$ 2,500.00	\$ 1,000.00	\$ 1,000.00	\$ 200.00	\$ 200.00	\$ 1,500.00	\$ 1,500.00	\$ 500.00	\$ 500.00
12	Locate Private Tile	25	STA	\$ 750.00	\$ 18,750.00	\$ 180.00	\$ 4,500.00	\$ 100.00	\$ 2,500.00	\$ 260.00	\$ 6,500.00	\$ 150.00	\$ 3,750.00
13	Exploratory Excavation	2	HR	\$ 300.00	\$ 600.00	\$ 350.00	\$ 700.00	\$ 180.00	\$ 360.00	\$ 580.00	\$ 1,160.00	\$ 225.00	\$ 450.00
14	Plug Existing Tile	2	LOC	\$ 1,450.00	\$ 2,900.00	\$ 350.00	\$ 700.00	\$ 200.00	\$ 400.00	\$ 385.00	\$ 770.00	\$ 500.00	\$ 1,000.00
15	Seeding	1	LS	\$ 2,000.00	\$ 2,000.00	\$ 1,000.00	\$ 1,000.00	\$ 2,500.00	\$ 2,500.00	\$ 3,500.00	\$ 3,500.00	\$ 500.00	\$ 500.00
16	Seeding Warranty	1	LS	\$ 1,000.00	\$ 1,000.00	\$ 1,000.00	\$ 1,000.00	\$ 2,500.00	\$ 2,500.00	\$ 100.00	\$ 100.00	\$ 500.00	\$ 500.00
<b>DD 9 Base Bid- Total (Bid Items 1 through 16)</b>				<b>\$ 193,944.80</b>		<b>\$ 123,700.00</b>		<b>\$ 152,387.00</b>		<b>\$ 125,334.00</b>		<b>\$ 117,010.00</b>	
<b>DD 9 ALTERNATE BID</b>													
1ALT	15" Ø RCP Tile	2530	LF	\$ 75.73	\$ 191,596.90	\$ 42.00	\$ 106,260.00	\$ 61.72	\$ 156,151.60	\$ 34.00	\$ 86,020.00	\$ -	\$ -
2ALT	18" Ø CMP Tile Outlet	40	LF	\$ 113.75	\$ 4,550.00	\$ 48.00	\$ 1,920.00	\$ 52.50	\$ 2,100.00	\$ 129.00	\$ 5,160.00	\$ -	\$ -
3ALT	Junction Structure with Intake	1	EA	\$ 5,000.00	\$ 5,000.00	\$ 4,000.00	\$ 4,000.00	\$ 1,483.00	\$ 1,483.00	\$ 6,380.00	\$ 6,380.00	\$ -	\$ -
4ALT	Concrete Collar	4	EA	\$ 1,975.00	\$ 7,900.00	\$ 250.00	\$ 1,000.00	\$ 600.00	\$ 2,400.00	\$ 250.00	\$ 1,000.00	\$ -	\$ -
5ALT	Private Tile Connection	4	EA	\$ 625.00	\$ 2,500.00	\$ 450.00	\$ 1,800.00	\$ 450.00	\$ 1,800.00	\$ 450.00	\$ 1,800.00	\$ -	\$ -
6ALT	12" Ø Hickenbottom Intake	2	EA	\$ 1,975.00	\$ 3,950.00	\$ 2,000.00	\$ 4,000.00	\$ 1,400.00	\$ 2,800.00	\$ 775.00	\$ 1,550.00	\$ -	\$ -
7ALT	Rip-Rap	40	TN	\$ 85.00	\$ 3,400.00	\$ 56.00	\$ 2,240.00	\$ 50.00	\$ 2,000.00	\$ 50.00	\$ 2,000.00	\$ -	\$ -
8ALT	Tile Removal	10	LF	\$ 400.00	\$ 4,000.00	\$ 20.00	\$ 200.00	\$ 4.00	\$ 40.00	\$ 24.00	\$ 240.00	\$ -	\$ -
9ALT	Fences	1	LS	\$ 1,500.00	\$ 1,500.00	\$ 1,500.00	\$ 1,500.00	\$ 200.00	\$ 200.00	\$ 1,500.00	\$ 1,500.00	\$ -	\$ -
10ALT	Rebuild Terrace	2	LS	\$ 1,980.00	\$ 3,960.00	\$ 1,500.00	\$ 3,000.00	\$ 420.00	\$ 840.00	\$ 1,500.00	\$ 3,000.00	\$ -	\$ -
11ALT	Outlet Shaping	1	LS	\$ 2,500.00	\$ 2,500.00	\$ 1,000.00	\$ 1,000.00	\$ 200.00	\$ 200.00	\$ 1,500.00	\$ 1,500.00	\$ -	\$ -
12ALT	Locate Private Tile	25	STA	\$ 750.00	\$ 18,750.00	\$ 180.00	\$ 4,500.00	\$ 100.00	\$ 2,500.00	\$ 260.00	\$ 6,500.00	\$ -	\$ -
13ALT	Exploratory Excavation	2	HR	\$ 300.00	\$ 600.00	\$ 350.00	\$ 700.00	\$ 180.00	\$ 360.00	\$ 580.00	\$ 1,160.00	\$ -	\$ -
14ALT	Plug Existing Tile	2	LOC	\$ 1,450.00	\$ 2,900.00	\$ 350.00	\$ 700.00	\$ 200.00	\$ 400.00	\$ 385.00	\$ 770.00	\$ -	\$ -
15ALT	Seeding	1	LS	\$ 2,000.00	\$ 2,000.00	\$ 1,000.00	\$ 1,000.00	\$ 2,500.00	\$ 2,500.00	\$ 3,500.00	\$ 3,500.00	\$ -	\$ -
16ALT	Seeding Warranty	1	LS	\$ 1,000.00	\$ 1,000.00	\$ 1,000.00	\$ 1,000.00	\$ 2,500.00	\$ 2,500.00	\$ 100.00	\$ 100.00	\$ -	\$ -
<b>Division 1 Alternate Bid - Total (Bid Items 1 ALT through 16ALT)</b>				<b>\$ 256,106.90</b>		<b>\$ 134,820.00</b>		<b>\$ 178,274.60</b>		<b>\$ 122,180.00</b>		<b>\$ -</b>	
<b>DD 9 ADD ALTERNATES BID</b>													
1ADD	Mandrel Testing of Tile	2570	LF	\$ 1.55	\$ 3,983.50	\$ 3.00	\$ 7,710.00	\$ 3.00	\$ 7,710.00	\$ 5.00	\$ 12,850.00	\$ 5.00	\$ 12,850.00
2ADD	CCTV Inspection of Tile	2570	LF	\$ 3.51	\$ 9,020.70	\$ 3.00	\$ 7,710.00	\$ 3.75	\$ 9,637.50	\$ 8.00	\$ 20,560.00	\$ 5.00	\$ 12,850.00
3ADD	Trench Compaction	25.7	STA	\$ 500.00	\$ 12,850.00	\$ 500.00	\$ 12,850.00	\$ 350.00	\$ 8,995.00	\$ 120.00	\$ 3,084.00	\$ 500.00	\$ 12,850.00
4ADD	Mandrel and CCTV Access Point	2	EA	\$ 5,000.00	\$ 10,000.00	\$ 2,000.00	\$ 4,000.00	\$ 2,000.00	\$ 4,000.00	\$ 6,380.00	\$ 12,760.00	\$ 2,000.00	\$ 4,000.00
<b>DD 9 ADD Alternates - Total (Bid Items 1ADD through 4ADD)</b>				<b>\$ 35,854.20</b>		<b>\$ 32,270.00</b>		<b>\$ 30,342.50</b>		<b>\$ 49,254.00</b>		<b>\$ 42,550.00</b>	

\*Mathematical Error

# Contractor's Qualification Statement

SUBMITTED TO: Clapsaddle-Garber Associates, Inc.  
739 Park Avenue  
Ackley, Iowa 50601

SUBMITTED BY: Farm Tile Pro  
\_\_\_\_\_  
\_\_\_\_\_

NAME OF PROJECT: DD9 Upper Main Tile Diversion

TYPE OF WORK

<input type="checkbox"/> Concrete	<input checked="" type="checkbox"/> Underground Utilities
<input type="checkbox"/> Asphalt	<input checked="" type="checkbox"/> Drainage
<input checked="" type="checkbox"/> Grading/Dirtwork	<input type="checkbox"/> Sewer Inspection/Televising
<input type="checkbox"/> Jack & Boring	<input type="checkbox"/> Other _____

## COMPANY INFORMATION:

How many years has your company been in business as a Contractor?

8 years

Under what other or former names (and what years) has your company operated?

If your company is a corporation, answer the following:

Date of Incorporation: 1-1-2012

State of Incorporation: Iowa

President's name: Dallas Kuper

If your company is a partnership, answer the following:

Date of organization: 1-1-2012

Type of partnership: LLC

Name(s) of general partner(s):

Dallas Kuper, Kelly Kuper

If your company is individually owned, answer the following:

Date of organization:

Name of owner:

List of equipment that will be used by your company for this project:

John Deere 210 w/ TopCon GPS  
John Deere 345 w/ TopCon GPS  
John Deere 850K Dozer w/ TopCon GPS  
3336 skid loader  
1356 Excavator with packer



**LICENSING**

List trade categories to which your company is legally qualified to do business, and indicate registration or license numbers for the State of Iowa:

General Contractor # C132836

**EXPERIENCE**

List the type of work that your company normally performs:

Grading / Dirt work, Tiling, water & sewer

List major construction projects your company has in progress, giving the names of project owners, contract amount, percent complete and scheduled completion. (Attach extra sheets if needed)

Cerro Gordo DD#33 Contract amount \$310,000 95% complete  
Franklin Co DD#18,34,7, Contract amount \$278,000, 0% complete

State total worth of work in progress and under contract:

\$500,000

List last ten major projects your company has completed in the past five years, stating nature of the project, owner, contract amount, date of completion and percentage of the cost of the work performed with your own forces.

- 2018 St. Ansgar Street & Utility Improvements \$980,000
- 2019 Rockford Drainage well closure \$400,000
- 2019 Rockwell DD33 County tile main \$310,000
- 2017 Osage Sewer improvements \$500,000

State average annual amount of construction work performed during the last five years:

\$3,000,000

State name of Project Supervisor: Dallas Kuper

Experience level of Project Supervisor and Field Crew:

15 years experience  
Top Con GPS Certified Contractor  
Iowa State Ag Business degree

**CLAIMS AND SUITS** (If you answer yes to any of the below, please attach details)

NA

Has your company ever failed to complete any work it has been awarded?

NA

Are there any judgments, claims, arbitration proceedings or suits pending or outstanding against your company or its officers?

NA

Has your company filed any lawsuits or requested arbitration with regard to construction contracts within the last five years.

NA

Within the last five years has any officer of your company ever been an officer for another company when it failed to complete a construction contract?

NA

**REFERENCES**

Professional References: Eric Stevens - 712-363-0372

Supplier References: Midwest pipe - 641-423-3801

Bank References: Home Trust 641-732-3763

Surety: CCI / Direct Surety

Name of bonding company: CCI Surety / Direct Surety

Name and address of the agent:

Tanya  
1710 N. Douglas Dr. Ste 110 Golden Valley, MN 55422

**FINANCING** – Statements to be submitted only if contract awarded.

Dallas Kure

Signature

Farm Tile Pro

Name of Company

Dated this 26 day of March, 2020

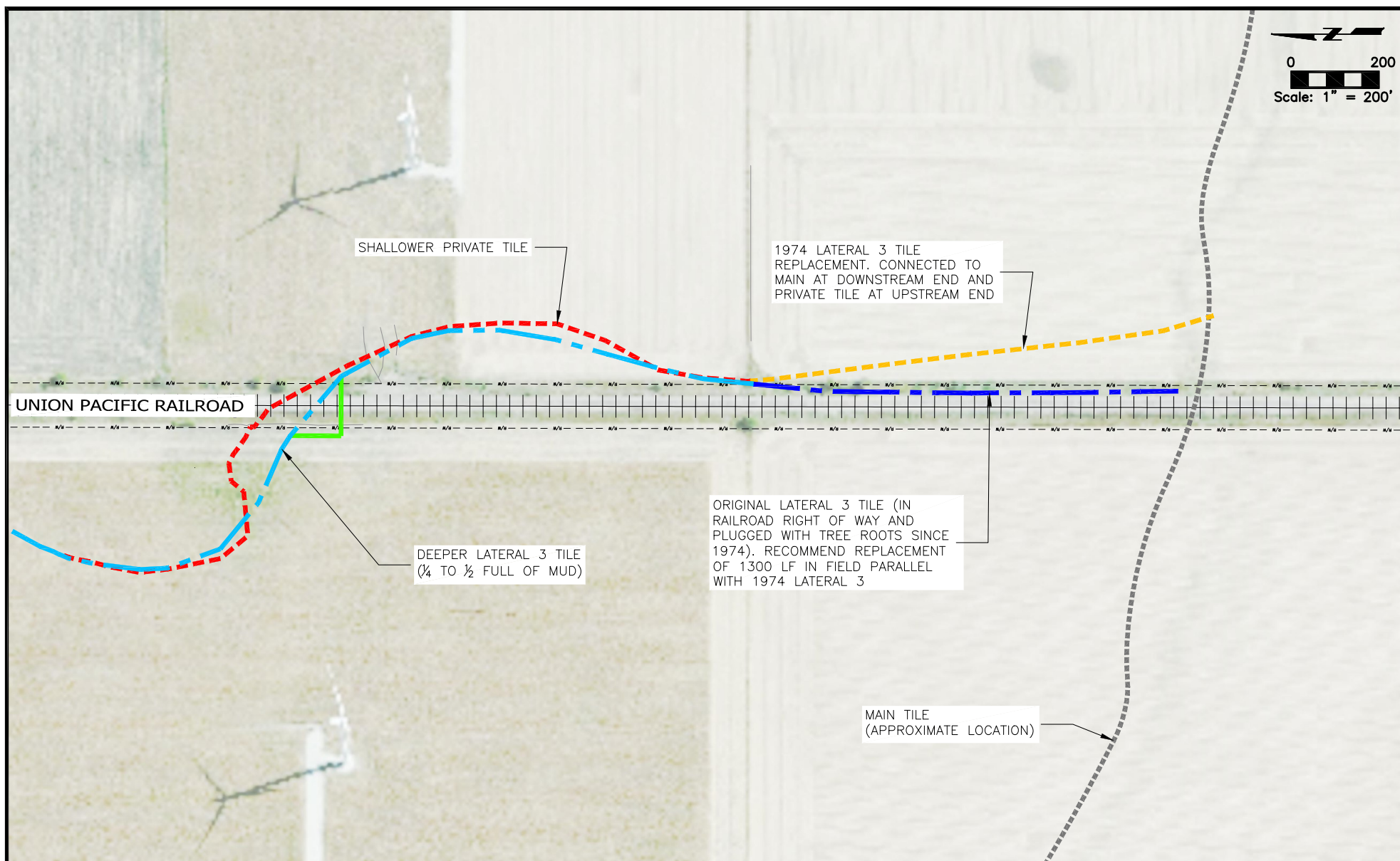
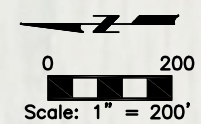

DRAWN BY: ZJS DATE: 2020-03-30 FIELD Bk:	APPROVED BY: LOG PROJ. NO.: 6501	REVISIONS:	 Clapsaddle-Garber Associates, Inc Main Office: 16 East Main Street Marshalltown, Iowa 50158 Ph 641-752-8701 www.cgaconsultants.com	ADDRESS: 739 PARK AVENUE ACKLEY, IOWA 50601 PH 641-847-3273 FAX 641-847-2303	PROJECT: REPAIRS TO MAIN AND LAT 3 DD 25 HARDIN COUNTY, IOWA 2020	SHT. NAME: INVESTIGATION MAP	SHT. NO.: 1 OF 1
--	-------------------------------------	------------	--	---	--	---------------------------------	---------------------



# Drainage Work Order Request For Repair

## Hardin County

**Date:** 3/31/2020

**Work Order #:** WO00000290

**Drainage District:** DDs\DD 14 (51027)

**Sec-Twp-Rge:** 34-88-22      **Qtr Sec:** SW NE & NW SE

**Location/GIS:** 88-22-34-200-004

**Requested By:** David Sweeney

**Contact Phone:** (641) 373-4340

**Contact Email:** \_\_\_\_\_

**Landowner (if different):** Cynthia Ioger

**Description:**

DD 14- 2 blowouts in waterway, 5' blowout N of drive is 4' deep w broken VCP tile in base, 3' blowout S of drive lane is 3' deep w broken VCP tile in base. Contractor should enter through the farmstead & drive down the lane to back of property.

**Repair labor, materials and equipment:** \_\_\_\_\_

\_\_\_\_\_

\_\_\_\_\_

**Repaired By:** \_\_\_\_\_ **Date:** \_\_\_\_\_

**Please reference work order # and send statement for services to:**

Hardin County Auditor's Office  
 Attn: Drainage Clerk  
 1215 Edgington Ave, Suite 1  
 Eldora, IA 50627  
 Phone (641) 939-8111  
 Fax (641) 939-8245

For Office Use Only

**Approved:** \_\_\_\_\_ **Date:** \_\_\_\_\_



# Drainage Work Order Request For Repair

## Hardin County

Date 3/31/2020 Work Order # \_\_\_\_\_  
District # #14 Lateral Main Tile Fund # \_\_\_\_\_  
Township \_\_\_\_\_ Section 34 Twp 88 Rge 22 Qtr Sec SW NE & NW SE

Repair Requested By David Sweeney  
Address 21547 Hwy S27, Alden, IA 50006 (also the repair location) Phone 641-373-4340

Landowner Cynthia loerger  
Address 19672 Hwy D15, Iowa Falls, IA 50126 Phone 641-640-2191

Request Taken By \_\_\_\_\_

Available for Repair Now?  Yes Date Available \_\_\_\_\_

Problem Description

Two blowouts in waterway:  
Blowout north of drive lane is 5 feet in diameter and 4 feet deep with broken VCP tile in the base.  
Blowout south of drive lane is 3 feet in diameter and 3 feet deep with broken VCP tile in the base.  
  
Contractor should enter through the farmstead and drive down the lane to the back of the property.

Repair labor, materials and equipment \_\_\_\_\_

Potential Wetlands?  Yes-Repair existing tile only  No-Repair and maintain tile

Repaired By: \_\_\_\_\_

Date: \_\_\_\_\_

Please send statement for services to:

Phone (641) 939-8111  
Fax (641) 939-8245

Hardin County Auditor's Office  
Attn: Tina Schlemme  
1215 Edgington Ave, Suite 1  
Eldora, IA 50627

For Office Use Only

Approved: \_\_\_\_\_ Date: \_\_\_\_\_





382234200004

NORTH BLOWOUT

382234200006

S27

SOUTH BLOWOUT

882234400001

882234400005

882234400006



South blowout





South blowout





North blowout





North blowout



# Drainage Work Order Request For Repair

## Hardin County

**Date:** 3/30/2020

**Work Order #:** WO00000289

**Drainage District:** DDs\DD 34 (51058)

**Sec-Twp-Rge:** 86-22-18      **Qtr Sec:** NE 1/4 NE 1/4

**Location/GIS:** 86-22-18-200-001

**Requested By:** Korey Hake

**Contact Phone:** (515) 689-1374

**Contact Email:** \_\_\_\_\_

**Landowner (if different):** Hidgins, Donald K Nancy L

**Description:** DD 34 - Korey Hake reports plugged tile/intake in ditch, ditch is full of water on both sides, roadbed is saturated and hole in side of road. Ponding in field on N side of rd, and water moving across Hake's field on the S side of rd. Located on 300th St, about 1/2 mile east of Zublin Ave.

**Repair labor, materials and equipment:** \_\_\_\_\_

\_\_\_\_\_

\_\_\_\_\_

**Repaired By:** \_\_\_\_\_ **Date:** \_\_\_\_\_

**Please reference work order # and send statement for services to:**

Hardin County Auditor's Office  
 Attn: Drainage Clerk  
 1215 Edgington Ave, Suite 1  
 Eldora, IA 50627  
 Phone (641) 939-8111  
 Fax (641) 939-8245

For Office Use Only

**Approved:** \_\_\_\_\_ **Date:** \_\_\_\_\_



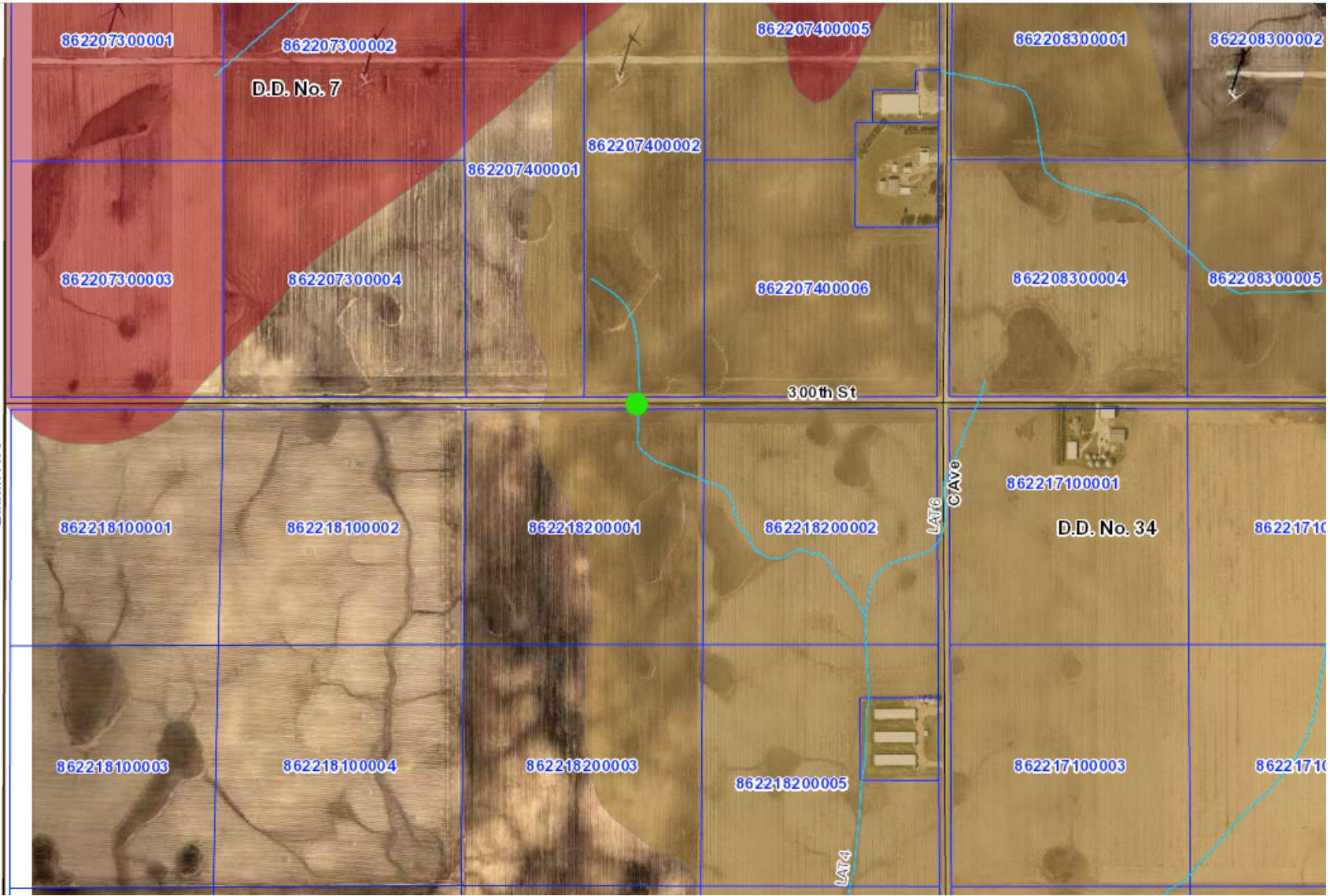



# Drainage Work Order Request For Repair

## Hardin County

**Date:** 3/31/2020

**Work Order #:** 2020-5

**Drainage District:** DDs\Big 4 Main (51193)

**Sec-Twp-Rge:** 04-89-22      **Qtr Sec:** Sect. 04, 05, 06, 08

**Location/GIS:** \_\_\_\_\_

**Requested By:** Midland Power - Casey Huff

**Contact Phone:** (515) 386-4111

**Contact Email:** chuff@midlandpower.coop

**Landowner (if different):** \_\_\_\_\_

**Description:** DD Big 4 - Overhead line rebuild, 4 miles, Alden Twp, Sections 04, 05, 06 and 08.

**Repair labor, materials and equipment:** \_\_\_\_\_

\_\_\_\_\_

\_\_\_\_\_

**Repaired By:** \_\_\_\_\_ **Date:** \_\_\_\_\_

**Please reference work order # and send statement for services to:**  
Hardin County Auditor's Office  
Attn: Drainage Clerk  
1215 Edgington Ave, Suite 1  
Eldora, IA 50627  
Phone (641) 939-8111  
Fax (641) 939-8245

For Office Use Only

**Approved:** \_\_\_\_\_ **Date:** \_\_\_\_\_



# HARDIN COUNTY

1215 EDGINGTON AVE., SUITE 1  
ELDORA, IA 50627  
(641) 939-8108

## HARDIN COUNTY DRAINAGE DISTRICT UTILITY PERMIT APPLICATION

Applicant: Midland Power Cooperative  
Company Name

1005 E Lincolnway  
Address

Jefferson IA 50129  
City State Zip

Applicant Contact: Casey Huff ( 515 ) 386 - 5814  
Name Phone

chuff@midlandpower.coop  
Email

Utility Type: overhead Electric

Drainage District(s) Crossed: Big Four

Facilities Crossed (specific tile, open ditch): \_\_\_\_\_

Description of Work: overhead line rebuild 4 miles, Alder township  
sections 04, 05, 06 and 08.  
(Location plan of proposed utility must be attached.)

Pursuant to Code of Iowa Section 468.186, approval is hereby requested for the right, privilege and authority to construct, operate and maintain utilities on, over, across or beneath established Hardin County Drainage Districts, subject to the attached Requirements for Construction On, Over, Across or Beneath Established Drainage District. Failure to comply with said requirements shall be ground for revocation of the permit by the Hardin County Board of Supervisors.

[Signature]  
Applicant Signature

3/25/20  
Date

Submit Form and Location Plan To: Hardin County Auditor's Office  
Attn: Drainage Clerk  
1215 Edgington Ave, Suite 1  
Eldora, IA 50627  
Fax (641) 939-8225  
[drainage@hardincountyia.gov](mailto:drainage@hardincountyia.gov)

For Office Use Only

Application Approval:  
By: \_\_\_\_\_ Date: \_\_\_\_\_  
*Board of Supervisor Chairman, Acting as Drainage District Trustee*  
APPROVED PERMIT #: \_\_\_\_\_





## REQUIREMENTS FOR CONSTRUCTION ON, OVER, ACROSS OR BENEATH ESTABLISHED DRAINAGE DISTRICT

Upon issuance of a permit for utilities on, over, across or beneath established Hardin County Drainage Districts, the applicant shall be governed by these requirements and shall comply with all conditions contained herein.

1. The Applicant shall furnish the Drainage District, or its representative, plats showing the exact location of the proposed construction. If it is found that such locations are in conflict with the present or proposed facilities and that a more desirable location is possible, the Applicant shall review such possible alignment changes. **No construction is to commence with the drainage facility without an approved application.**
2. Applicant shall comply with Iowa One-Call requirements prior to commencing any work.
3. The Drainage District shall provide Applicant access to maps or other information regarding the location of all known drainage district facilities so that reasonable care may be taken by Applicant to avoid un-necessary damage to said drainage district facilities.
4. The Applicant shall hold the Drainage District harmless from any damage that may result to the Drainage District facility because of the construction or maintenance of the utility, and shall reimburse the Drainage District for any expenditures that the Drainage District may have to make on said Drainage District facilities resulting from Applicant's construction and installation of utilities, or their subsequent repair or modification.
5. The Applicant shall take all reasonable precaution during the construction of said utility to protect and safeguard the lives and property of the public and adjacent property owners and shall hold the Drainage District harmless from any damages or losses that may be sustained by adjacent property owners on account of such construction operations. Further, Applicant agrees to replace, repair or reimburse all damages to private property occasioned by Applicant's installation of subsequent modification or repairs.
6. The Drainage District assumes no responsibility for damages to the Applicants property occasioned by any construction or maintenance operation of said Drainage District facilities, subsequent to Applicants installation.
7. A copy of a certificate of insurance naming the County/Drainage District as additional insured for their permit work shall be provided to the County Auditor prior to installation. The limit of liability under the insurance policy shall not be less than \$1,000,000 per occurrence.
8. The Applicant agrees to give the Drainage District twenty-four (24) hours (Saturday and Sunday excluded) notice of its intention to commence construction on any lands within the jurisdiction of the Drainage District. Said notice shall be made in writing to the County Auditor or to the designated Drainage District representative.
9. The Applicant agrees to place permanent, visible markers or monuments at locations where utility crosses Drainage District facilities. These monuments or markers shall identify the owners name, address and phone number.
10. The Drainage District Trustees may appoint a representative to inspect and approve all construction across Drainage District facilities as part of this permit. All compensation, wages, mileage and other expenses for this representative will be paid by the Applicant. It will be the responsibility of the Applicant to make all contacts with private parties (adjacent owners/operators) to determine the location of private drainage facilities. Said representative will also inspect all crossing of Drainage District facilities and may, if required, observe the crossing of private drainage facilities, and shall have the authority to require the Applicant to excavate and expose the crossing of any Drainage District facility where the representative believes it prudent to visually examine Applicants crossing of the Drainage District facility. Further, said representative has the authority to suspend construction and installation by the Applicant within any Drainage District jurisdiction by verbal order to the contractor at the site and a telephone call to Applicants contact person listed on page 1 within six (6) hours of the verbal order.





11. The construction and maintenance of Applicants installation shall be carried on in such a manner as to not interfere with or interrupt the function of said Drainage District facilities without the express written consent of the Drainage District Representative. In the event it becomes necessary to temporarily stop the flow of water, the following shall be completed by the Applicant:
  - a. If the crossing involves a tile line, the replacement of tile with approved materials, in the manner approved by the Drainage Districts designated representative, shall be performed as rapidly as possible. If the approved method of repair is impossible and the volume of water flowing in the tile is sufficient to create the possibility of crop loss or property damage, the Contractor will be permitted to temporarily block the tile line to prevent the flow of this tile water into the pipeline, or tile line ditch. In the event this tile line is so temporarily blocked, the Contractor will be expected to provide sufficient pumping equipment to pump the impounded tile water across the construction ditch to the undisturbed tile line. Such temporary blockages of said Drainage District tile lines will be removed as rapidly as possible and any tile repairs caused by this blockage will be immediately repaired at the Applicants expense.
  - b. If the crossing involves an open ditch that is carrying sufficient flow of water to make it necessary to place a temporary dam across said open ditch, such temporary dams may be constructed only upon approval from the Drainage District designated representative. The maximum elevation of this impounded water shall be determined by the designated Drainage District representative and all excess water must be allowed to flow across the construction ditch through either a closed metal culvert pipe or by pumping. All temporary dam structures are to be removed as soon as the crossing is completed. The construction and removal of these dams shall be in such a manner that the smooth and efficient function of the drainage ditch is not impaired, with all costs and damages borne by Applicant.
12. The Applicant will at any time subsequent to the commencement of construction, and at Applicants sole expense, reconstruct or replace its installation as may be necessary to conform to new grade or alignments resulting from maintenance or construction operations by the Drainage District in connection with any of its drainage facilities. Applicant agrees to do this within forty-five (45) days of receipt of written request from the Drainage District, or such longer time period as the Drainage District may specify, without cost to the Drainage District. Such reconstruction or realignment of Applicants improvements shall be made in accordance with and approved by the Drainage District or its designated representative. If the Applicant is unable to comply within the time period specified above, the Drainage District may cause the work to be done and the Applicant will pay the cost thereof upon receipt of a statement of such costs.
13. CROSSING OF OPEN DITCH FACILITIES. Utility crossings shall be constructed as follows, as directed by the designated representative of the Drainage District:
  - a. Passage of installation in a horizontal plane five feet (5') below design grade of drainage ditch, as established by the Drainage District representative.
  - b. The above depth to extend to a point two (2) times the design base width of ditch either side of centerline of drainage ditch (measured along the centerline of utility) unless the existing base width is greater than the design bases width. If the existing base width is greater than the design with, the depth is to extend to a point two (2) times the existing width.
  - c. The rate of slope for transition from normal utility laying depth of crossings of drainage ditches shall not be steeper than 4:1.
  - d. If such ditch crossings occur at points of outlets of Drainage District or private tile lines or within twenty-five feet (25') of said outlets, such outlets must be relocated to a point not less than twenty-five feet (25') from such crossings. Such relocations shall be at the expense of the Applicant and as directed by the representative of the Drainage District.





14. CROSSING OF DRAINAGE DISTRICT TILE LINES. Utility crossings shall be constructed as follows, as directed by the designated representative of the Drainage District:
- a. All proposed installations must be placed under the existing Drainage District tile lines. These requirements may be waived only upon the review by and approval of the designated representative of the Drainage District. Such waiver must be in writing.
  - b. A minimum of one foot (1') clearance below existing Drainage District facilities must be maintained.
  - c. At all crossings of Drainage District tile lines with the proposed utility, one of the following must be used:
    - i. Replace Drainage District tile with reinforced concrete pipe of same or larger diameter than existing tile. Concrete pipe to be 2,000 D strength (Iowa Department of Transportation approved) with standard tongue and groove joints. Pipe to have a minimum of three (3) bolt-type connectors at each joint.
    - ii. Replace Drainage District tile with cathodic protected corrugated metal pipe. Diameter of corrugated metal pipe to be a minimum of two inches (2") larger than outside diameter of tile line being replaced. (Specifications regarding gage, cathodic protection and other details to be subject to review and approval.)
    - iii. Dual wall plastic with specific approval of Drainage District representative.
    - iv. Bore new utility installation; maintain existing tile in an undisturbed state.
  - d. The length of tile to be replaced by any of the above alternates is as follows:
    - i. Eight-inch (8") tile and smaller: Six feet (6') either side of centerline of proposed installation, measured at right angles to the centerline of installation.
    - ii. Ten inch (10") tile and larger: Ten feet (10') either side of centerline of proposed installation, measured at right angles to the centerline of installation.
  - e. At all crossings of Drainage District tile lines where the Drainage District and private tile lines are damaged by the construction, maintenance or repair of Applicants installation shall be repaired as directed by the Drainage Districts designated representative.
15. This permit is subject to existing regulations and statutes of the State of Iowa and future regulations, which may be promulgated or enacted.
16. This application is subject to revocation by Hardin County, if in its judgment it is necessary for legitimate purposes. In such event, written notice shall be provided to permit holder.
17. Applicant agrees to pay all other legitimate costs, fees and expenses associated with its crossing of the Drainage District facility, including but not limited to, publication costs, engineering costs and legal service costs. Said costs will be paid within thirty (30) days of the mailing of the statements to the Applicant.
18. Applicant agrees to provide a copy of as-built plan of the utility route and location, showing route changes that may have taken place during construction.
19. Applicant agrees to include a copy of these requirements to all bidding specifications; or if the construction and installation contract has been let by the time this permit is approved, Applicant agrees to provide a copy of these requirements to the contractor and to advise them that they are bound by the terms of these requirements.